



Smart Toilet Series

USER INSTRUCTIONS

Smart Technology That Understands You
Automatic Smart Toilet

Safety directory

Please read carefully before installation and use.

WARNING: To avoid electric shock

1. Do not expose the electronic components to direct water contact.
2. Do not drop the remote control into water.

Warning: To avoid burns, fires and injuries

1. Children and users with temperature sensitivity issues should be supervised by others when using this product.
2. Use only the functions described in this manual. Do not use other equipment with this product.
3. Do not continue using the product if it malfunctions, is damaged, or has been flooded. Contact an authorized service center for repairs.
4. Ensure that electrical wires are not damaged by heat or fire.
5. Do not use this product when impaired or not fully alert.
6. Do not block or obstruct the toilet or drainage pipes.
7. Do not use the toilet outdoors.

Initial Setup and First Use

Note: To ensure the normal use of the product, please follow the instructions.

1. Plug the power cord into a 110V AC outlet.
2. Verify that the digital display panel is functioning.
3. Ensure the water inlet valve is open.
4. Verify that the hose between the angle valve and toilet inlet valve is properly connected.

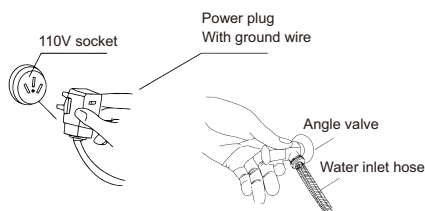

Caution

1. Check for leaks in the spray nozzles or water pipes by drying all pipe connections and testing with absorbent paper.
2. Test for sounds by pressing the seat near the seat sensor.
3. Verify that the cleaning, drying, automatic deodorization, and automatic flushing functions are working properly.
4. Check that the soft-close mechanism is working.

Seating sensor

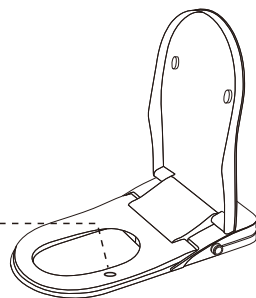

Check the cleaning, drying, and automatic deodorization functions. Ensure the sensor is activated.

Cover the spray nozzle when testing the cleaning function to avoid splashing.

Safety Caution

Note: Please read all instructions carefully before use.

Please read carefully before using. The cautions listed here are safety-related and must be followed. 

This is an electrical product. Do not install it where it may be splashed with water or in areas with high humidity. When installing in a bathroom, ensure proper ventilation to maintain adequate airflow.

The electrical outlet should be positioned as follows:

- The electrical outlet should be positioned at least 12 inches above the floor and as far as possible from the bathtub.
- The electrical circuit should be protected by a high-speed ground fault circuit interrupter (GFCI) with a response current of less than 15 mA, or by an isolation transformer rated between 1.5 KVA and 3 KVA.

Warning - Be sure to firmly connect ground wires 

This product uses a three-prong plug (with ground wire). Electric shock may occur if there is an electrical fault or current leakage. If your outlet is not grounded, consult a qualified electrician. Use only 110V AC power supply as required by local electrical codes.



This product requires a proper ground connection. Failure to ground the unit properly may result in electric shock.

Note: Proper grounding requires a grounding resistance below 100Ω, and the electrical panel's grounding wires must be copper wire with a diameter greater than 1.6mm.

When installing in a bathroom, ensure the power plug is waterproofed with silicone sealant or appropriate weatherproofing.

*Using the wrong power supply may result in fire.

Observe the following precautions:



Do not urinate on the spray nozzles or sensors.

Unplug the unit during thunderstorms.

Do not spray water directly on the toilet for cleaning.
Do not wipe the seat and cover with abrasive materials or rough paper.

Do not open the toilet seat or lid forcefully.

- May cause cracking or malfunction.



If the toilet will be exposed to freezing temperatures, drain water lines and take appropriate winterization measures to prevent damage.



Do not place heaters near this product.

- Discoloration or malfunction may occur.



Safety Caution

Note: Please read carefully before using.

Please read carefully before using.

The cautions listed here are related to safety and please follow.



Must obey

Notice heat burn

- Lower the seat temperature or turn it off when sitting for extended periods.
- Set the temperature to room temperature when the following persons use the toilet:

- Children, elderly, sick, or disabled individuals
- People who have taken sleeping medication, are intoxicated, or are extremely tired

Do not use any power source other than AC 110V

- May cause fire

Keep cigarettes and other ignition sources away from the product

- May cause fire

Do not use loose or damaged electrical outlets

- May cause fire or electric shock

Do not spray water on or rinse the electronic components or power plug.

- May cause fire or electric shock
- May cause the toilet to break, malfunction, or result in water damage

When not in use for extended periods, unplug the unit.

- Unplug for safety
- Before reusing, run water through the system for one minute to flush the lines

Do not flush anything other than urine and feces

- May cause blockages and sewage overflow

Do not unplug the power cord with wet hands

- May cause electric shock

Do not twist or damage the water inlet

- May cause leaks



Prohibit

Do not continue using the product if it malfunctions

When any of the following occurs, unplug the unit, close the angle valve, and shut off the water supply:

- The toilet bowl is leaking
- Cracks appear in the ceramic
- Abnormal sounds or odors
- Smoke or fumes are emitted
- Overheating occurs
- The toilet is clogged

Continued use under these conditions may cause fire, electric shock, or water damage.

Avoid damaging the power cord or control cables

- Do not pull
- Do not modify or alter
- Do not expose to heat
- Do not bend forcefully
- Do not place heavy objects on the power cord or control cables

Damage may cause fire, electric shock, or short circuit. If the power cord is damaged, contact a qualified technician for repair.

Do not disassemble, repair, or modify the product without authorization

- May cause fire or electric shock

Do not use extension cords

- May cause fire or electric shock

Do not install this product in excessively damp areas without proper ventilation

- May cause fire or electric shock

Do not use contaminated or dirty water

- May cause skin irritation or other health problems

Additional Features

Note: Please read the following carefully before use

Manual Flushing

Use the flush button on the remote control or control panel to flush the toilet.

Manual seat and lid operation

Remote/Manual Control: Press the button on the remote control or control panel to open/close the seat and lid

Motion-sensor automatic lid opening

Motion-activated operation: The lid opens and seat heater activates when you approach. When you leave, the heater turns off and the toilet flushes automatically.

Daily cleaning and maintenance

Note: During cleaning and maintenance, turn off the power and unplug the unit.

Smart toilet cleaning and maintenance guidelines

Wipe with a soft cloth dampened with clean water.

- Clean dirt promptly as it becomes harder to remove over time. Wipe regularly with water.

- Static electricity attracts dust, causing discoloration and dirt buildup.

Regular cleaning with a damp cloth prevents static buildup.

- The toilet seat can be removed from the ceramic base for thorough cleaning between components.

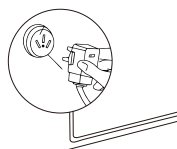

Unplug the power supply before maintenance

Spray Head Cleaning and Maintenance

If dirt accumulates in the nozzle, clean it with a small brush such as a toothbrush.

Do not pull or bend the spray head

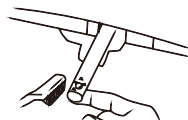

IMPORTANT

Clean dust from the power plug regularly

When cleaning, unplug the unit and wipe the plug with a dry cloth.

- Poor insulation may cause fire

Side knob instructions



Power on/off:

Long press the knob for more than 3 seconds

Rear Wash:

Turn the knob left

Front Wash:

Turn the knob right

Stop:

Press the knob once

Flush:

Press the knob once before sitting

Air Dry:

Press the knob once while seated

Emergency Flush:

Emergency operation: Connect the backup battery and press the knob for 3 seconds during power outages to flush.

1. Toggle motion sensor for lid operation: Press and hold the lid button on the remote control for 5 seconds
2. Turn on/off automatic flush when standing up: Press and hold the automatic flush button on the remote control for 5 seconds
3. Turn on/off flush-on-lid-close function: Press and hold both the lid and flush buttons on the remote control simultaneously

With Auto Open Cover Flip Remote Control

Note: Please read the following carefully before use

STOP



You can stop rear wash, front wash, drying, and other functions during operation.

SPRAY/MASSAGE



Press this button while seated to activate the rear wash nozzle. It will spray water for 2 minutes and then stop automatically.

BIDET/MASSAGE



Press this button while seated to activate the front wash nozzle. It will spray water for 2 minutes and then stop automatically.

DRYER



Press this button while seated to start the warm air drying function. Drying will stop automatically after 3 minutes.

POSITION ADJUST



Press this button during rear wash or front wash to adjust the nozzle position while the cleaning function continues.

PRESSURE ADJUST



Increases or decreases the cleaning water pressure. Can be set to weak, medium, strong, or maximum.

LID TOGGLE



Press this button to open the lid automatically. Press again to close the lid automatically.

SEAT TOGGLE



Press this button to open the seat automatically. Press again to close the seat automatically.

FLUSH



Press this button to start flushing.

WATER TEMP



Four temperature settings are available:

- Level 1: Room temperature
- Level 2: Approximately 93°F
- Level 3: Approximately 96°F
- Level 4: Approximately 99°F

SEAT TEMP



Four temperature settings are available:

- Level 1: Room temperature
- Level 2: Approximately 93°F
- Level 3: Approximately 96°F
- Level 4: Approximately 99°F

AIR DRY TEMP



Four temperature settings are available:

- Level 1: Room temperature
- Level 2: Approximately 93°F
- Level 3: Approximately 96°F
- Level 4: Approximately 99°F



Remote control pairing

Turn the knob to rear wash for approximately 3 seconds. When you hear a beep, press any button on the remote control to complete pairing.

CHILD WASH



After the child is seated, press the baby wash button to automatically start gentle rear cleaning at the lowest pressure setting. Press the button again to activate oscillating wash mode. Press the "Stop" button to end the baby wash cycle.

NOZZLE CLEAN



Automatically extends the nozzle and flushes it with water for cleaning.

LIGHT



Toggles the night light on or off when the unit is powered on.

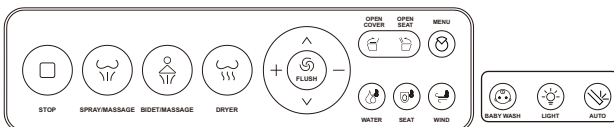

Remote Control with Auto-Open Lid Function

Note: Please read the following carefully before use.

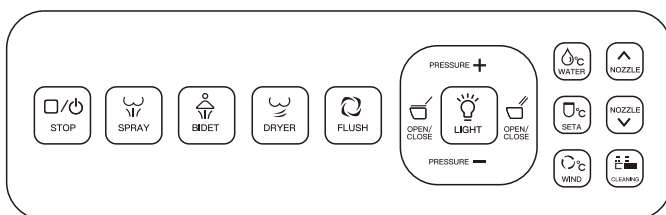

POWER



Press this button to turn the power on or off.

DRYING



Press this button while seated to start the warm air drying function. Drying will stop automatically after 3 minutes.

STOP



You can stop rear wash, front wash, drying, and other active functions during operation.

REAR/MOBILE



Press this button while seated for rear wash with moving spray pattern. It will operate for 2 minutes and then stop automatically.

FLUSH



Press this button to start flushing.

FEMALE/MOBILE



Press this button while seated for front wash with moving spray pattern. It will operate for 2 minutes and then stop automatically.

PRESSURE ADJUST



Increases the cleaning water pressure. Can be set to weak, medium, strong, or maximum.

NIGHT LIGHT



Toggles the night light on or off when the unit is powered on.

POS. FORWARD



Press this button during rear wash or front wash to move the nozzle position forward while the cleaning function continues.

PRESSURE DOWN



Decreases the cleaning water pressure. Can be set to weak, medium, strong, or maximum.

NOZZLE CLEANING



The nozzle extends and rinses itself with water for self-cleaning.

POS. BACKWARD



Press this button during rear wash or front wash to move the nozzle position backward while the cleaning function continues.

Water Temperature



Four temperature settings are available:

- Level 1: Room temperature
- Level 2: Approximately 93°F
- Level 3: Approximately 96°F
- Level 4: Approximately 99°F

Seat Temperature



Four temperature settings are available:

- Level 1: Room temperature
- Level 2: Approximately 93°F
- Level 3: Approximately 96°F
- Level 4: Approximately 99°F

Air Dry Temperature



Four temperature settings are available:

- Level 1: Room temperature
- Level 2: Approximately 93°F
- Level 3: Approximately 96°F
- Level 4: Approximately 99°F

This button only works when the automatic sensor lid function is enabled.

COVER



Press this button to open the lid automatically. Press again to close the lid automatically.

SEAT



Press this button to open the seat automatically. Press again to close the seat automatically.

CODE FOR REMOTE CONTROL

Turn the knob to the rear wash position and hold for about 3 seconds. After hearing a beep, press any button on the remote control to complete pairing.

Note: If the remote control does not respond on the first attempt, repeat the coding process.

Troubleshooting Guide

Note: If you experience any of these problems, try the following solutions or contact customer service.

Fault phenomenon	Fault analysis	Fault handling
Product doesn't work	Check if power connection is loose	Check the electrical circuit
	Check for electrical leakage (GFCI indicator shows protection is off)	Unplug unit, reset GFCI switch. If problem persists, unplug and contact repair service
No water when spraying	Check if water supply is shut off	Wait for water supply restoration
	Check if angle valve is closed	Open the angle valve
	Check if inlet filter is clogged	Clean or replace filter
	Check for bent inlet pipes	Clear pipe obstruction
Cleaning pressure insufficient	Check if pressure is set to lowest level	Adjust water pressure per manual instructions
	Check if inlet filter is clogged	Clean or replace filter
Spray pattern erratic	System malfunction	Unplug unit, wait one minute, reconnect and test
Water temperature too low	Check if temperature setting is too low	Adjust water temperature per instructions
	Check if hot/cold massage function is enabled	Disable hot/cold massage function per instructions
Washer drips continuously	Solenoid valve malfunction	Contact qualified service technicians
Remote control not working	Check if battery is low	Replace the battery
Seat/drying temperature too low	Check if set to low or room temperature	Adjust temperature per instructions
	Check if power saving mode is enabled	Disable power saving mode per manual
Seat/lid closes too quickly	Soft-close mechanism malfunction	Contact qualified service technicians
Cleaning function not working	Check if body sensor is blocked	Clear sensor area
	Check if power restored after outage	Verify power supply
	Check if user positioned properly on sensors	
	Sensor malfunction	Contact qualified service technicians
Seat/lid will not open or close (Automatic sensor models only)	Automatic soft-close mechanism failure	1. Unplug unit, wait one minute, reconnect and test 2. If problem persists, contact qualified service technicians
Low water pressure, poor cleaning	Filter clog	Clean the filter according to instructions
	Bent pipes	Check water supply lines for kinks and ensure smooth flow
Weak flush, poor cleaning despite normal water pressure	Air leak at sewage outlet	Contact qualified service technicians
	Blocked trapway	Contact plumber for drain cleaning
Flush ineffective despite normal water pressure	Flush valve malfunction	Contact qualified technicians for service

Specifications may vary slightly due to product updates. Please check your actual product for exact details.

Product standard

Rated voltage	Alternating voltage 110V±10%, 50HZ/60HZ		
Rated power	Water inlet temperature: 59°F Outlet water temperature: 99°F Water discharge: 750ml/min Power: 1350W		
Cleaning	Water outlet	Hip cleaning	About 700 ml/min
		Female cleaning	About 700 ml/min
	Outlet water temperature		Normal temperature, and 93°F/96°F/99°F(4 grades)
	Water heating		Instant water heater
	Heater power		Water inlet temperature: 59°F , Outlet water temperature: 99°F Water discharge: 750ml/min Power: 1350W
Seat heating	Seat temperature		Normal temperature, and 93°F/96°F/99°F(4 grades)
	Heater power		40W
Warm drying	Wind temperature		Normal temperature, and 93°F/96°F/99°F(4 grades)
Spray position			Adjustable Fore and Aft
Water temperature			41~99°F
Water Pressure (With Water Tank)			The lowest pressure : 0.06 Mpa the highest pressure : 0.75 Mpa (static)
Water Pressure (Without Water Tank)			0.15-0.75 Mpa (static) is about 5L of water in 15 seconds

Specifications may vary slightly due to product updates. Please check your actual product for exact details.